



+39 059 928 900
+39 059 922 156

RAM
ELETTRONICA
CUTTING SYSTEMS

info@ramcutting.com
www.ramcutting.com

reshaping the world of cutting...

RAM SPL EV AUTOMATIC FAST OSCILLATING BLADE CONTOUR CUTTING MACHINE



SPL EV: HIGHLIGHTS

- Application areas: Mattress, Upholstery furniture, Insulation, Automotive, Packaging.
- Focused on quality and reliability you can depend on.
- Redefined extended range-density PURs cutting precision of shapes featuring sharp edges and smallest radii of curvature: the widest working range ever.
- Versatility redefined by means of a high-frequency reciprocating blade enabling hi-repeatability cutting standards even with extra-high density PURs.
- Outstanding cutting speed performances, while providing a thorough job.
- Productivity-oriented refined designed handheld:
 - Display of a live camera for an immediate positioning into the material;
 - Machine and cutting tools usage statistics for monitoring the assets.
- Rugged low maintenance and quick setup machine.
- Extremely reduced administration costs:
 - Low energy consumption by means of the revolutionary mass-reduced system;
 - Rock bottom swarf (wastage) quantity and reduced setup times.

PAG. 1/6

SEDE OPERATIVA E LEGALE:
VIA DELLA MECCANICA, 9/11
41018 SAN CESARIO S.P.
MODENA - ITALY

DOMICILIAZIONE POSTALE:
C.P. 84
41013 CASTELFRANCO EMILIA



+39 059 928 900
+39 059 922 156

RAM

ELETRONICA

CUTTING SYSTEMS

info@ramcutting.com
www.ramcutting.com

reshaping the world of cutting...

SPL EV: STRENGTHS

THE PRIORITY IS NOW THE SUSTAIN OF GROWTH, THE "FULFILMENT OF CUSTOMER NEEDS" IS NO LONGER ENOUGH

No weak spots for such an uncompromisingly fast, accurate and versatile cutting machine: it provides a unique blend of high performances and precision allowing the cutting of elaborate shapes from extended range-density PURs.

Easily manage your cutting patterns by means of the RAM Software, featuring a superior compatibility derived by the capability of importing, exporting and managing common DXF files: flexibility and performance are the key words!

The newly conceived optional LCD handheld, enables for the first time the monitoring of the stand-alone machine productivity, giving a view over the cut essential data, and a reliable control on the cutting tools, recording the quantities and the life-span performance for each blade. On the same display, a live video taken from the blade-view can be activated for easing and speeding up the tool positioning inside the material.

Hedging the operative costs has been a constant aim underlying the project as a whole: the groundbreaking counterweightless system grants the most favourable balance to the sliding cutting unit, which reveals itself to be much lighter -therefore energy saving thanks to the lower moving masses- than a conventional one.

An extreme attention to the details and the accuracy of the project is clearly indicated by the multiple joint frames ensuring maximum stiffness of the whole at the highest operational speeds.

The specifically designed quick-assembly super long-lasting serrated blade ensures the highest-efficiency process cycle.

The RAM SPL EV also features a powered turntable for cross contouring purposes.

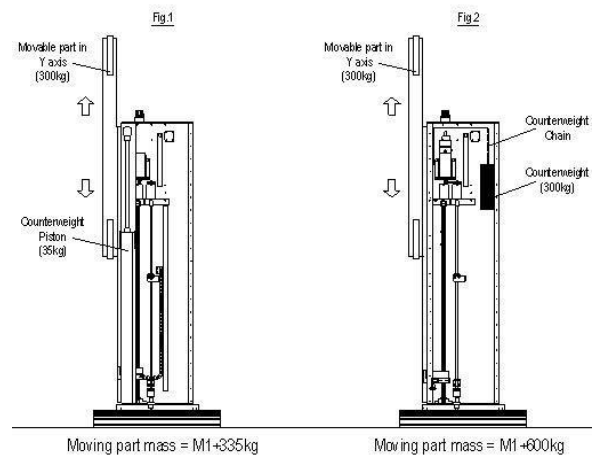

SEDE OPERATIVA E LEGALE:

VIA DELLA MECCANICA, 9/11
41018 SAN CESARIO S.P.
MODENA - ITALY

DOMICILIAZIONE POSTALE:

C.P. 84
41013 CASTELFRANCO EMILIA



+39 059 928 900
+39 059 922 156

info@ramcutting.com
www.ramcutting.com

reshaping the world of cutting...

SPL EV: TECHNICAL DATA SHEET & LAYOUT

Standard model DIMENSIONS (mm)			
MACHINE			BLOCK (standard)
	OVERALL	W/ CE SAFETY CAGES	MAX
WIDTH (mm)	3700	4745	2200
LENGHT (mm)	3860	4745	2200
MAX HEIGHT (mm)	3300	=	1290

CONNECTIONS	
POWER SPECS	Power supply: 230 V @ 50 Hz
	Power peak: < 4 kW
PNEUMATIC SPECS	Pressure: 8 Bar

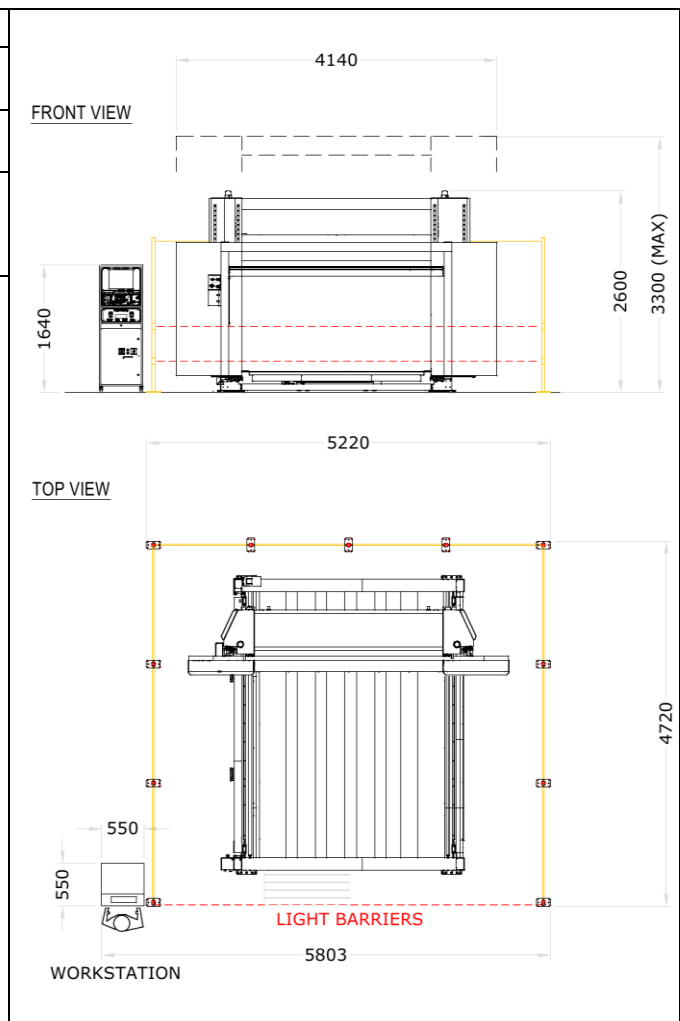



reshaping the world of cutting...

SPL EV: ELECTRONIC CONTROL UNIT

(The CAM SW is subject to the terms and conditions set forth in the EULA)

The design of a customized computer chassis realizes some advantages thanks to the possible integration with the other relevant thermal players inside the closed cabinet box. The study of all the thermal sources considered at once let the definition of an obstacle-free route for the extraction air guaranteeing a very stable working temperature for all the internal components. Furthermore this solution is limiting the need of an expensive air conditioner, leaving its application to very extreme cases only.

A customized frame structure and engineered location of all the involved components, solves in a practical way all the connection wires routing. In fact one of the most frequent causes of bad air circulation, but yet still highly underestimated, are wires tangles. A lower operating temperature for all the components is ensuring a much longer operational life. A faster maintenance has been achieved as well as all the components are in view and easily reachable in first grade (no need to disassemble another component in order to get access to the one of interest).

SOFTWARE FEATURES:

- Fully automated patterns setup system prompting the highest-efficiency arrangements according to the block dimensions;
- Automated patterns setup system manual override;
- Cutting path simulation;
- Cutting sequence display;
- Windows 8.1 compatible software;
- Remote assistance software preinstalled;
- Complete system's initial state backup for customer autonomous quick recovery.

CNC HARDWARE FEATURES:

- High speed industrial grade components based computer;
- High resolution LCD display;
- Fast start up time (< 20 sec from power off to Windows 8 Desktop);
- Heat dissipating design for a long lasting operational life;
- Noise reduction precautions;
- Manual remote control unit;
- Easy accessibility and quick maintenance;
- Smart design for *unstoppable* performances: if an emergency occurs causing an immediate stop of the cut (emergency button pressed or someone inside the safety-critical zone), when the situation has been restored the machine can simply restart and complete the cut from the freezing point without any need of homing;
- Led diagnostic synoptic panel;
- Integrated and sleek design providing handy RAM contacts and servicing information.

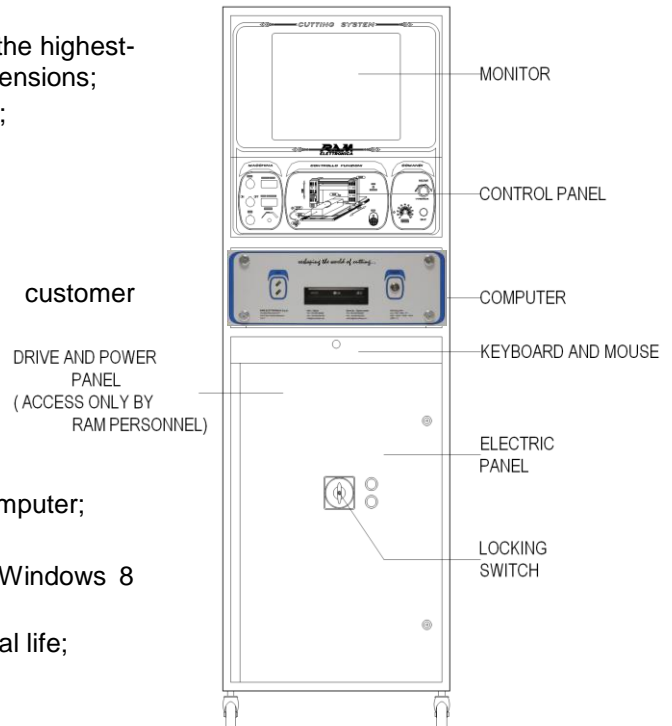



reshaping the world of cutting...

POLIES CAD SYSTEM (OPTIONAL)

HARDWARE:

- 16-keys cursor templates capturer digitizing table (optional).
- High-speed computer featuring a high-res graphics card.
- High resolution LCD monitor.



MODULAR RAM CAD END USER LICENSED SOFTWARE:

- TEMPLATES CAPTURE MODULE:
Cushy direct survey of any planar paper template by means of the Digitizer table, allowing:
 - Template(s) instant check while being captured.
 - Digitalized patterns check and adjustment.
 - Simple capturing and management of bigger-than-the-Digitizer table templates.
- PATTERNS MAKING UP AND HANDLING MODULE:
 - Onscreen pattern making up feature.
 - Complete or limited pattern(s) alteration.
 - Patterns geometric features and dimensions check.
 - Adjustable templates internal library.

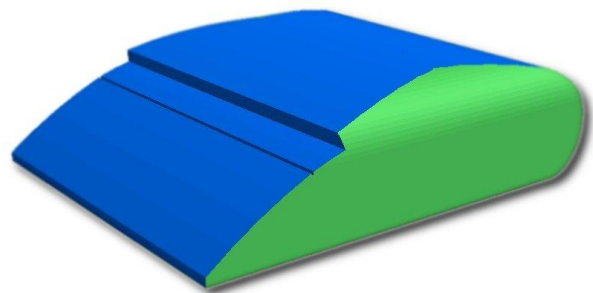
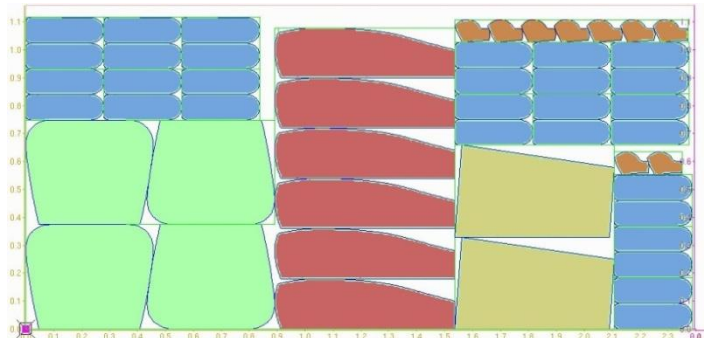



+39 059 928 900
+39 059 922 156

RAM
ELETTRONICA
CUTTING SYSTEMS

info@ramcutting.com
www.ramcutting.com

reshaping the world of cutting...

- **PATTERN ARRANGEMENT MODULE:**
 - Single or multiple pattern(s) arrangement feature.
 - Raw material waste hedging by means of differently shaped patterns management within the same arrangement.
 - Processing-time saving custom-made cutting paths setup.

- **GENERATION OF FLAWLESS CUTTING PATH FILES BY MEANS OF THE BUILT-IN AUTOMATIC RAW DATA PROCESSING AND CHECKING MODULE**

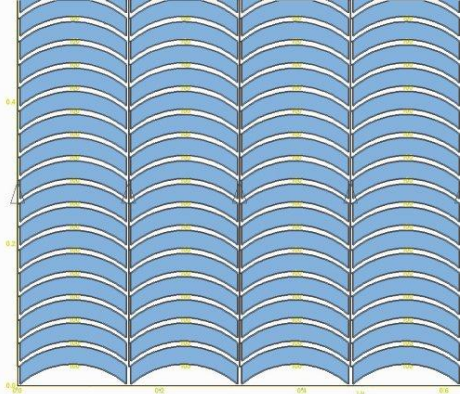

*The a/m sw programs feature an embedded multilingual user interface.
All sw programs by RAM ELETTRONICA.*

This brochure is a publication of RAM Elettronica S.p.A.. Products offered for sale may differ from those described or illustrated in this brochure. The contents of this brochure are therefore to be treated as representations as to the current availability of products as described, or as to products actually offered for sale. All product illustrations and specifications are subject to change. RAM Elettronica S.p.A. reserves the right to make alterations to the described models, equipment and specifications - at any time without prior notice or obligation - which are considered necessary for the purpose of product improvement.

PAG. 6/6

SEDE OPERATIVA E LEGALE:
VIA DELLA MECCANICA, 9/11
41018 SAN CESARIO S.P.
MODENA - ITALY

DOMICILIAZIONE POSTALE:
C.P. 84
41013 CASTELFRANCO EMILIA